

'At any time' waiting restrictions

A double yellow line means that no parking is allowed at any time. Please remember that:

- all double yellow line restrictions operate 24 hours a day, seven days a week, including bank holidays
- you may stop to load or unload for up to 20 minutes on yellow lines, provided you are not causing an obstruction
- if you are a Blue Badge holder you are entitled to park for 3 hours on any yellow lines provided that you are not causing a hazard or obstruction and the clock card is displayed and set to your time of arrival.
- double yellow lines are sited for safety reasons, in areas where parking could pose a serious obstruction to other road users (including emergency services)
- double yellow lines do not require a time plate next to them stating that no parking is allowed
- vehicles may be removed if they are found to be contravening the restriction



Old Kent Road – Integrated Waste Management Facility Proposed waiting, loading, prescribed route project scope

November 2010

How can I have my say?

It is very important that this consultation accurately reflects the views of residents and businesses. We won't know what you think unless you tell us.

Should you wish to make any comments on the proposed restrictions shown overleaf, please do so by writing to us and using the enclosed Freepost envelope provided or by emailing parkingreview@southwark.gov.uk

Please provide your name and full address on any correspondence.

Consultation closes: Friday 17 December 2010

What happens next?

Once we have taken into consideration the results of the consultation, a final design will be presented to Rotherhithe Community Council in January 2011.

As you will appreciate, Southwark Council receives many comments from consultations and we are therefore unable to respond personally to each representation. However all comments and suggestions will be taken into consideration before a final decision is made.

For further information on how and where to park in Southwark please visit www.southwark.gov.uk/parking

To arrange a translation of this leaflet please take it to:

**One Stop Shop – 122 Peckham Hill Street, London SE15, or
One Stop Shop – 151 Walworth Road, London SE17, or
One Stop Shop – 17 Spa Road, London SE16, or
Southwark Town Hall – Peckham Road, London SE5.**

للتدريب لترجمة هذه الكراسة خذها رجاء إلى أحد العنواين التاليين:

Para obtener una traducción de este folleto, llévelo a:

Bu broşürün tercüme edilmesini düzenlemek için lütfen onu aşağıdaki yerlerden birine götürün:

Để có bản dịch tiếng Việt, hãy mang tờ rơi này đến cửa hàng:

Pour une traduction de ce dépliant, présentez-le à l'un des guichets uniques suivants :

এই প্রচারপুস্তিকাটির (লিফলেটের) একটি অনুবাদের আয়োজন করতে হলে দয়া করে এটি এখানে নিয়ে যান:

為獲取此單張的翻譯版本，請將單張帶到以下一駐式辦事處：

Dear resident, business owner/occupier,

Southwark Council is committed to effective on-street parking for residents, businesses and visitors to the borough.

Background

Southwark Council's planning committee has granted permission for Veolia Environmental Services to build an Integrated Waste Management Facility (IWMF) at the former gas works site on Old Kent Road.

The facility will be built and operated by Veolia Environmental Services on behalf of the council. It will play a central role in helping to reduce the impact that Southwark's waste has on the environment. It is expected to facilitate a significant improvement in the borough's recycling levels as well as diverting most of the waste that would previously have gone to landfill.

To enable the IWMF to work effectively some modifications are required to the road network. These changes are shown on the enclosed plan and summarised as:

- Construction of a new road. This public highway will provide the exit road from the IWMF onto Old Kent Road.
- Installation of a one-way traffic system. Vehicles will enter "in" via Devon Street and "out" via the new road.
- Installation of a "no motor vehicles" restriction in Devonshire Grove. This will prohibit motor vehicles from driving through Devonshire Grove from a point approximately 30m north-west of Old Kent Road to its junction with Devon Street.

What are we consulting upon?

Additional to the above modifications, we need to ensure that the expected increase in vehicular traffic can pass along Devon Street and the new exit road without obstruction or tail-backs.

We want to know if you have any comments upon the proposed parking restrictions in Devon Street and the exit road. In particular the extent of the parking restrictions.

The proposed parking restrictions are shown on the enclosed plan and summarised as:

- 1) At any time waiting restrictions – Devon Street and the new exit road**
The installation of at any time waiting restrictions (double yellow lines) to ensure that vehicle access to and from the Integrated Waste Management Facility site is maintained at all times.
- 2) Parking places – Devon Street**
A section of Devon Street will remain unrestricted to enable parking for businesses and its visitors



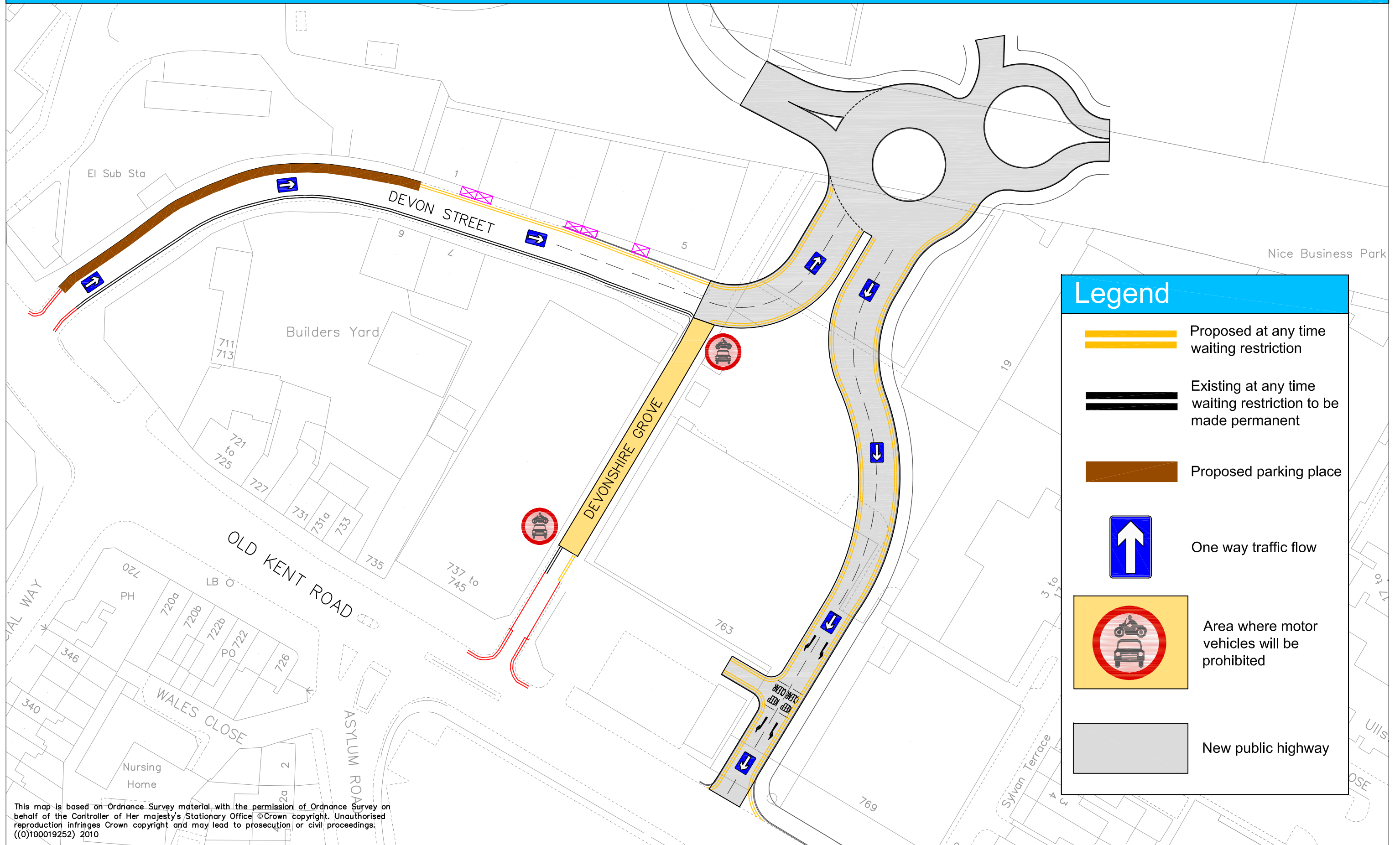

Old Kent Road - Integrated Waste Management Facility

Proposed waiting restrictions

APPENDIX 2

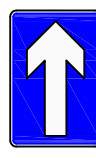

Legend

-  Proposed at any time waiting restriction
-  Existing at any time waiting restriction to be made permanent
-  Proposed parking place
-  One way traffic flow
-  Area where motor vehicles will be prohibited
-  New public highway

This map is based on Ordnance Survey material with the permission of Ordnance Survey on behalf of the Controller of Her Majesty's Stationary Office © Crown copyright. Unauthorised reproduction infringes Crown copyright and may lead to prosecution or civil proceedings. ((0)100019252) 2010